



Stretch belt
tool

K 10445



INRODUCTION

This tool facilitates the job of replacing a stretch belt. Because the belt drive in this case does not include a tensioner, the belt can not be un-tensioned and re-tensioned. Instead the belt is stretched so it can be put in place.

SAFETY AND PRECAUTION

- Always read and follow the instructions from the vehicle manufacturer.
- Make sure the ignition is off to eliminate the risk of the engine starting.
- Use safety goggles and safety gloves.
- Always tighten components to the manufacturers recommended torque settings.
- Always turn engine in its normal Direction of Rotation (DOR).
- Avoid contaminating the belt or pulleys with lubricants and anti-freeze.
- Avoid trapping fingers between the belt and pulley.

OPERATION INSTRUCTIONS

For ease of use it is recommended that spark plugs/heater plugs shall be removed to reduce the engine compression.

Removal

- 1 Fit removal tool A (pict.1) on the crank shaft pulley as described in picture 2.
- 2 Using an appropriate ratchet wrench, turn the engine in its normal direction of rotation, picture 3, until the belt comes of.

Installation

- 1 Feed the new belt around the auxiliary drive pulleys, leave the crank shaft till last.
- 2 Fit installation tool B (pict.1) on the crankshaft pulley as described in picture 4.
- 3 Using an appropriate ratchet, turn the engine in its normal direction of rotation, picture 5, until the belt goes on the crank shaft pulley. Important: Once the belt is in its place, remove the tool and turn the crankshaft further one turn to check that the belt is well seated. If not the procedure must be repeated.

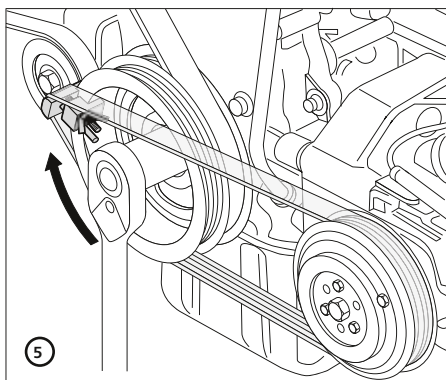
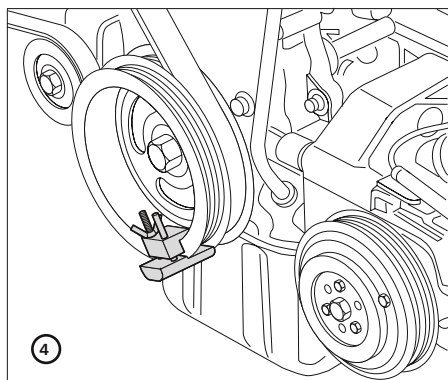
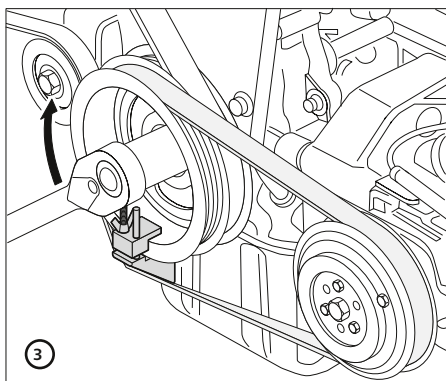
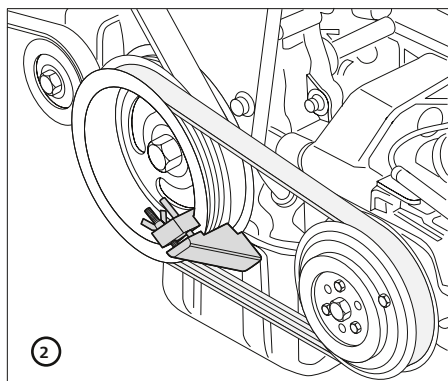
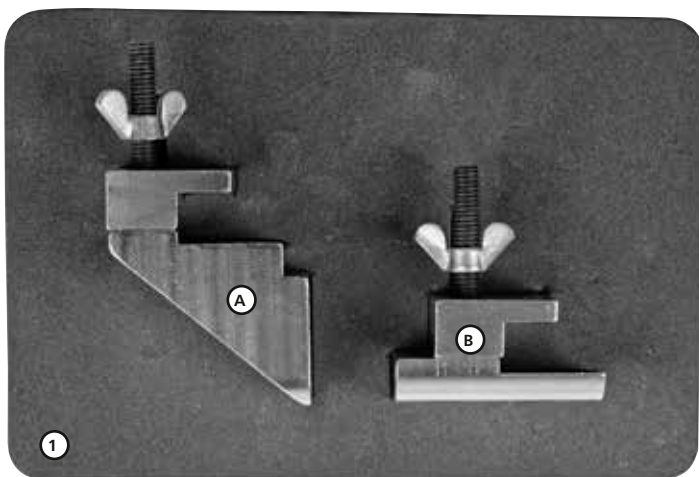



K 10445

www.kamasatools.com