



Inner bearing  
race puller set

K 10638



## **INRODUCTION**

This tool is designed for a safe and convenient removal of the inner bearing race from wheel hubs. Other methods using angle grinders, welding torches, etc. creates a very high risk of damaging the hub or causing personal injury.

## **SAFETY AND PRECAUTION**

- Support the lifted car in a safe manner.
- Make sure to use the correct size collet and attach the bearing race puller carefully to avoid personal injury or damage to the vehicle
- Use safety goggles and gloves

## **MAINTENANCE**

- Always keep the tool clean in order to avoid wear and bad functionality.
- Grease the spindle regularly, this will protect the threads from wear.

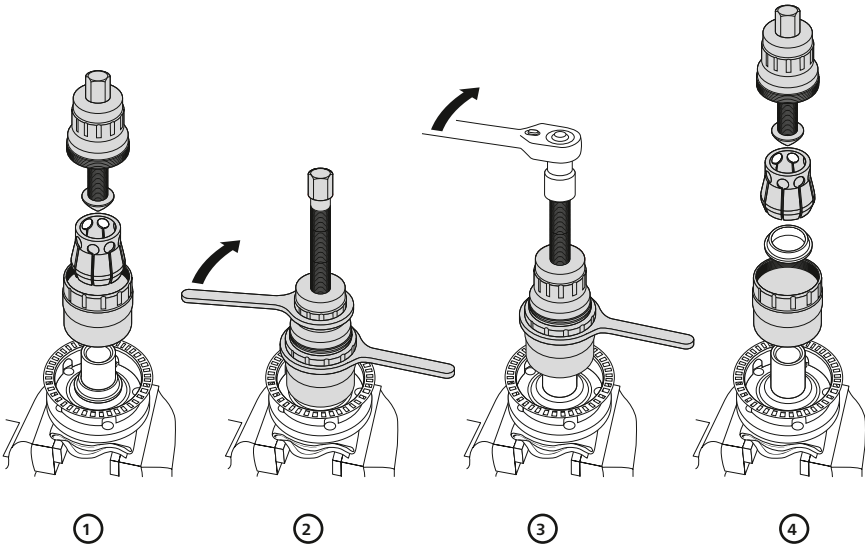

## OPERATION INSTRUCTIONS

Position numbers refer to the parts list illustration on next page.

- 1 Measure the inner bearing race and chose a suitable collet (1–4)
- 2 Remove the clamping ring and insert the collet in the chuck (5).
- 3 Install the clamping ring on the chuck without compressing the collet.
- 4 Put the tip (6) on the spindle and screw it back enough to install the assembled tool over the bearing race.
- 5 Using the two clamping keys (7–8), tighten the tool over the inner bearing race.
- 6 Using a ratchet wrench with a 22 mm socket, screw the spindle in until the bearing race comes off.

**Note:** Never use impact wrench when working with this tool, it may destroy the threads.

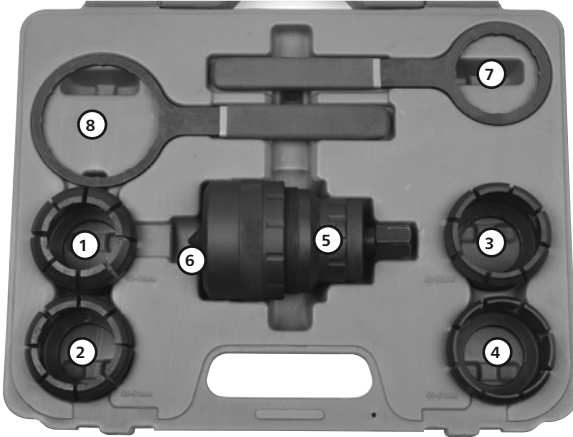

## PARTS LIST

Pos.	Stock No.	Description
1	K 10660	Collet Ø 40–45 mm
2	K 10661	Collet Ø 45–51 mm
3	K 10662	Collet Ø 50–55 mm
4	K 10663	Collet Ø 55–61 mm
5	K 10664	Collet chuck
6	K 10665	Spindel tip
7	K 10666	Key Ø 58,9 mm
8	K 10667	Key Ø 82,7 mm

K 10638

[www.kamasatools.com](http://www.kamasatools.com)