

Kamasa-TOOLS®

Bosch
common rail
injector tool set

K 440



SAFETY AND PRECAUTION

Always follow instructions provided by the vehicle manufacturer regarding handling and safety measures.

PRODUCT SPECIFICATIONS

For removing Bosch Diesel injectors. This tool set offers three alternative ways to remove the injector, two by knocking and one by pressing.

OPERATION INSTRUCTIONS

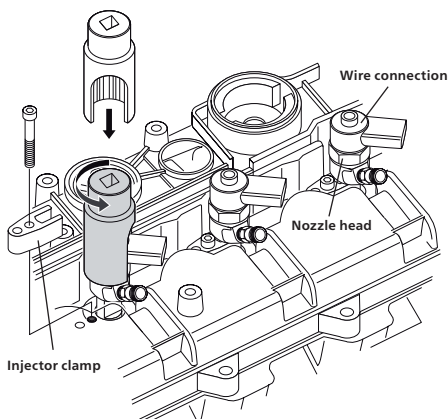

1. Remove the fuel lines and wire connections. Use a injector nozzle socket (K 430–K 434) to remove the nozzle head. Also remove the injector clamp.

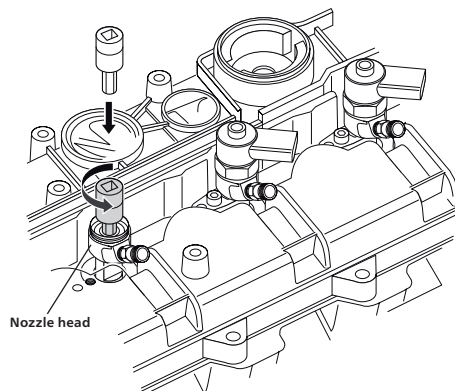

2. Use a 10 mm hex bit socket to remove the threaded plug.

ALTERNATIVE 1

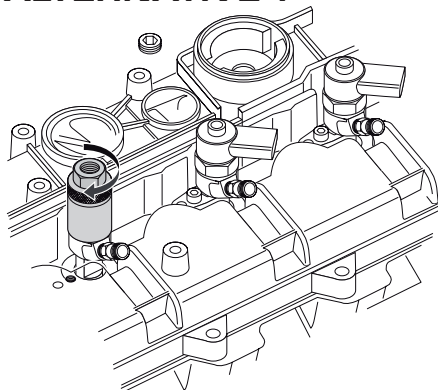

3. Screw the adapter, KR 440 3, to the outside threads on the injector.

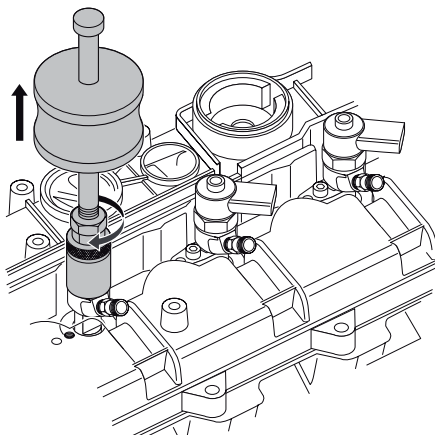

4. Attach the slide hammer, KR 440 4 and rod KR 440 5, to the adapter and knock out the injector.

ALTERNATIVE 2

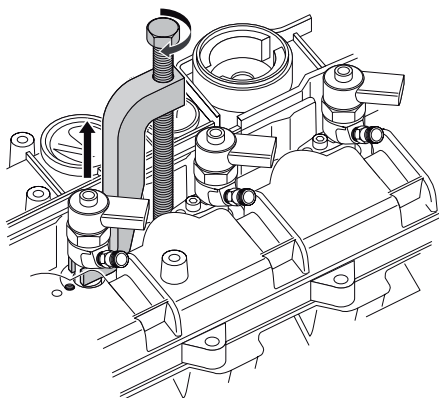

3. For injectors with 12 mm fork recess and anvil surface on the cylinder head.

Remove the injector clamp. Attach the threaded rod, KR 440 7, to the fork, KR 440 2.

Make sure the threaded rod is aligned over the anvil and screw down the rod to lift the injector.

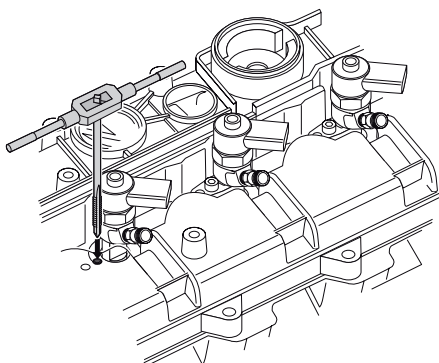

5. Before the ejector clamp is reinstalled, clean the threads with the tap, KR 440 6.

ALTERNATIVE 3

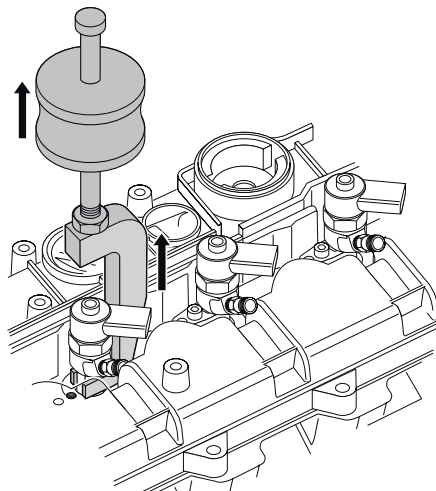

3. For injectors with 12 mm fork recess where the cylinder head does not have an anvil to support the screw.

Attach the slide hammer, KR 440 4 and the rod, KR 440 5, to the fork, KR 440 1. Place the fork in the recess and knock out the injector.



SPARE PARTS

Pos.	Stock No.	Description
1	K 440 1	Fork
2	K 440 2	Fork
3	K 440 4	Hammer
4	K 440 3	Adapter
5	K 440 7	Screw
6	K 440 5	Rod
7	K 440 6	Tap

K 440

www.kamasatools.com